

Decorative Street Lighting Poles



المير للصناعات ALMEER INDUSTRIES

www.almeer.com.kw



شركة المير للخدمات الفنية ذ.م.م.

Subsidiary of **ALMEER TECHNICAL SERVICES CO. W.L.L.**





INTRODUCTION

Almeer Industries established in the year 1997, has been in the business offering a wide range of services in manufacture of Panels for various applications, Street Lighting Poles, Street Light Fixture HPS & LED, Junction Boxes, Cable Trays & Accessories, Unistrut Channels, Wire mesh, Expanded metal, Profiled Sheets etc., for Oil & Gas, Petrochemical, Power and other major industries in Kuwait. It is an ISO 9001: 2008, ISO 14001: 2004 & ISO 18001: 2007 Certified Company with standardization worked into all facets of its work.

Almeer manufacturing facility is located in Amghara Industrial Area with modern machineries and equipments. The workshop is located on 16,000 Sq.mtrs of area which consists of Overhead Office, Stores and well laid down area for fabrication, machine shop, CNC Operation, Lighting Pole Machinery, Industrial blasting, Power coating plant, Hot-dip galvanization plant and computerized, manual & chemically etched engraving facilities. The workshop is equipped with overhead crane for material handling and other maintenance services.

We stride to provide reliable, highest quality and economic solutions to our customers. As we continue to build and strengthen our partnership, we are committed to achieve 100% customer satisfaction and earn your trust and loyalty.



- 2** INTRODUCTION
- 5** ALUMINUM DECORATIVE POLES
- 7** DECORATIVE GARDEN LIGHT POLE 4-12M
- 8** DECORATIVE POLES GARDENIA: TECHNICAL DRAWINGS - 4-12 M
- 9** DECORATIVE POLES GARDENIA: LANTERNS
- 10** DECORATIVE POLES ARABIAN: 8 - 12M
- 11** DECORATIVE POLES ARABIAN: BRACKET TECHNICAL DRAWINGS)
- 13** MILD STEEL
- 14** DECORATIVE POLES FOR STREET LIGHTING:
QATAR DECORATIVE POLE (SINGLE ARM)
- 16** DECORATIVE POLES FOR STREET LIGHTING:
QATAR DECORATIVE POLE (DOUBLE ARM)
- 18** DECORATIVE POLES FOR STREET LIGHTING:
OMAN-DUQM-MUSCAT HIGHWAY
- 20** MS DECORATIVE POLES FOR ENTRANCES AND WALKWAY AREA:
ARCH LONGITUDINAL POLE
- 23** MESH POLES
- 24** MESH POLES: GEOMETRIC MESH 1M
- 26** MESH POLES: ARABIAN MESH 1M
- 28** MESH POLES: ORIENTAL MESH 1M
- 30** TREE POLES



A. ALUMINUM DECORATIVE POLES

A.1 DECORATIVE POLES GARDENIA

A.2 DECORATIVE POLES ARABIAN

A.1 DECORATIVE POLES GARDENIA 4, 6, 8, 12M HIGH



A.1 DECORATIVE POLES GARDENIA 4, 6, 8, 12M HIGHT

SPECIFICATION

Garden Lighting Pole with Two Lamps

Height: 4 meter - 6 meter

Top Golden Decoration Part Height: 360mm

Thickness of the Arm and Pipe: 3mm

Top Part pipe height: 2140mm

Diameter of Top part: Ø76mm

Middle Part Height: 2500mm

Diameter of Middle Part: Ø114mm

Basement Height: 1000mm

Diameter of the Base Flange: Ø420mm*T:20mm

Wall Thickness of the Basement: 8~10mm

The pole with the straight line on the surface finished by Hot Dip Galvanized and Polyester

Lamp: Die-Cast Aluminum

Lamp Frame: PC Plastic

Reflector: High Pure Aluminum

Sockets: E27/E40

Watts: 150W

RENDER

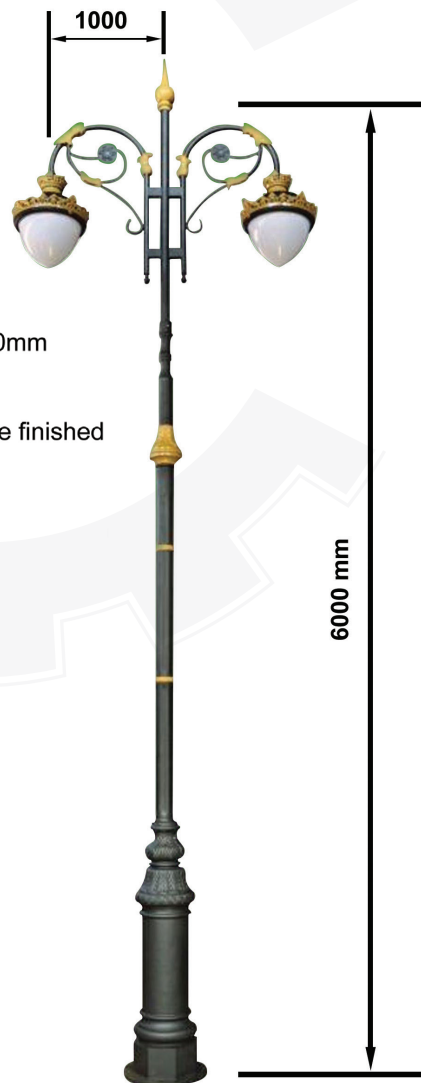

BASE PLATE

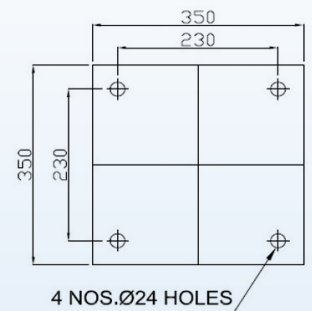

A.1 DECORATIVE POLES GARDENIA: TECHNICAL DRAWINGS - 4-12 M

SINGLE ARM

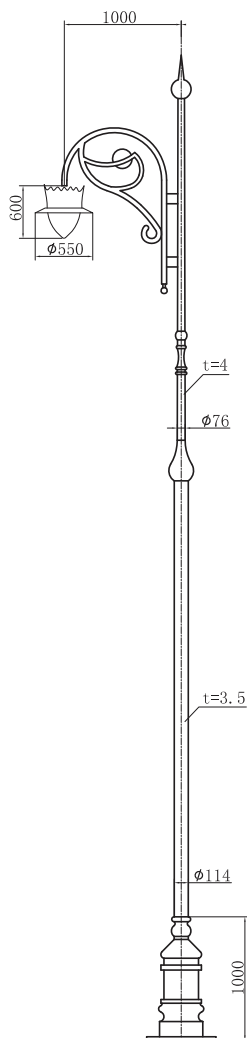

DOUBLE ARM

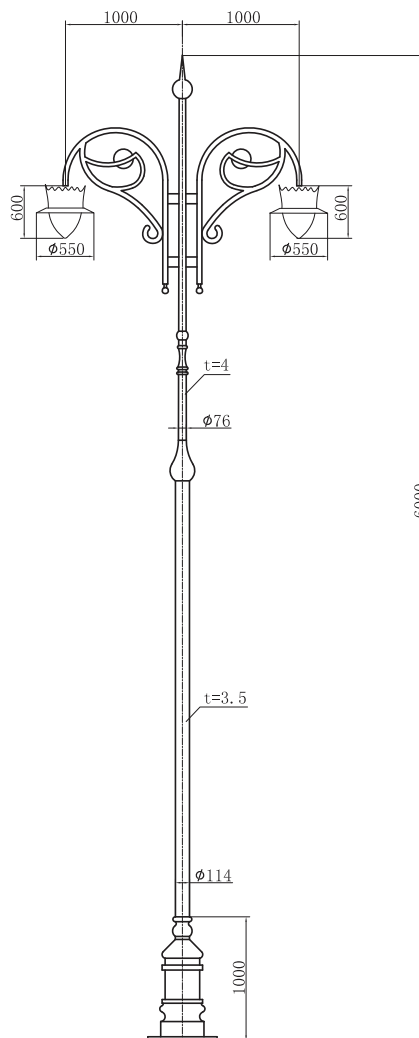

BASE PLATE DETAIL

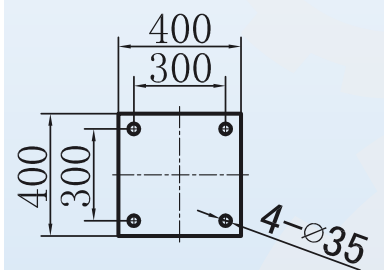

A.1 DECORATIVE POLES GARDENIA: LANTERNS

| SPECIFICATION | DETAILS | DIMENSION |
|---|---|---|
|  | <ul style="list-style-type: none"> Lamp: Die Cast Aluminium Lamp: Frame: PC Plastic Reflectors: Pure Aluminium Sockets: E27/E40 Watts: 160 W |  |
|  | | |



A.2 DECORATIVE POLES ARABIAN: 8-12M



A.2 DECORATIVE POLES ARABIAN: BRACKET TECHNICAL DRAWINGS

SINGLE ARM

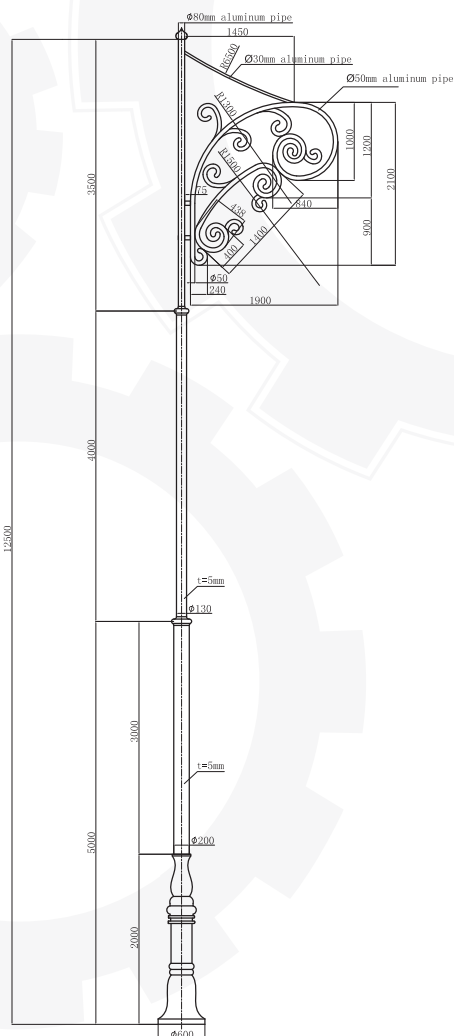

DOUBLE ARM

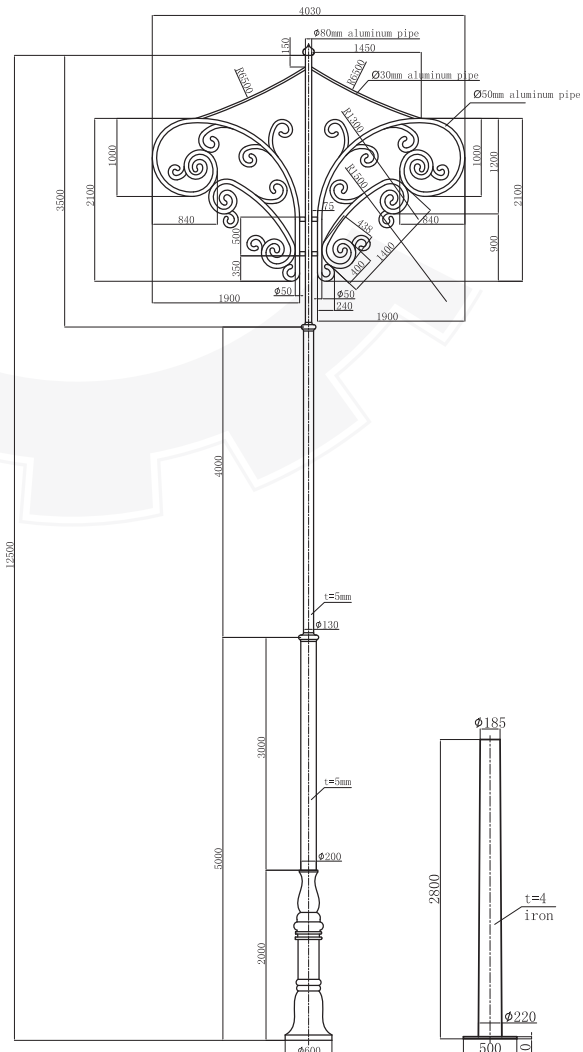

BASE

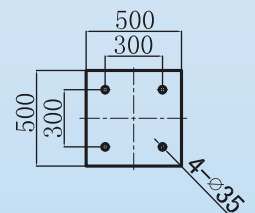



B: MILD STEEL

B.1 MS DECORATIVE POLES FOR STREET LIGHTING

B.2 MS DECORATIVE POLES FOR ENTRANCES & WALKWAY AREAS

B.3 MESH POLES

B.4 TREE POLES

B.1 DECORATIVE POLES FOR STREET LIGHTING: QATAR DECORATIVE POLE (SINGLE ARM)



B.1 DECORATIVE POLES FOR STREET LIGHTING: QATAR DECORATIVE POLE (SINGLE ARM)

TYPE A- WITH ALUMINIUM SPIKE

TYPE B

TECHNICAL

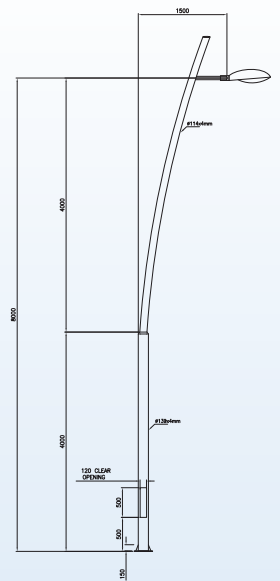

BASE PLATE DETAIL

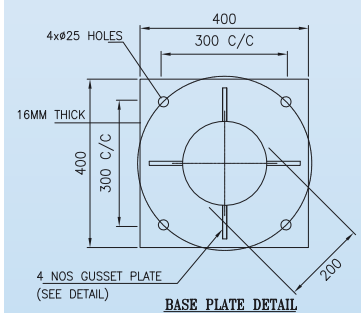



B.1 DECORATIVE POLES FOR STREET LIGHTING: QATAR DECORATIVE POLE (DOUBLE ARM)



B.1 DECORATIVE POLES FOR STREET LIGHTING: QATAR DECORATIVE POLE (DOUBLE ARM)

TYPE A- WITH ALUMINIUM SPIKE



TYPE-B



TECHNICAL

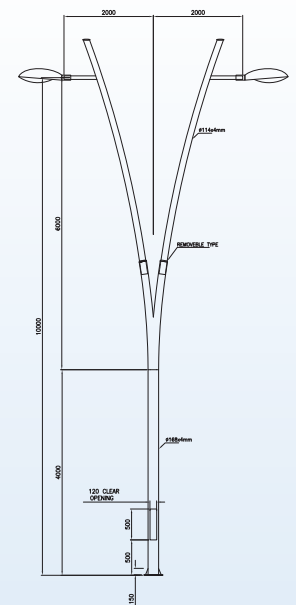

BASE PLATE DETAIL

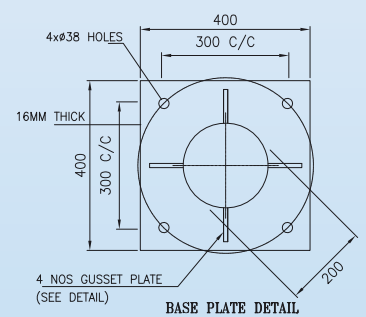

B.1 DECORATIVE POLES FOR STREET LIGHTING: OMAN-DUQM-MUSCAT HIGHWAY



B.1 DECORATIVE POLES FOR STREET LIGHTING:

RENDER

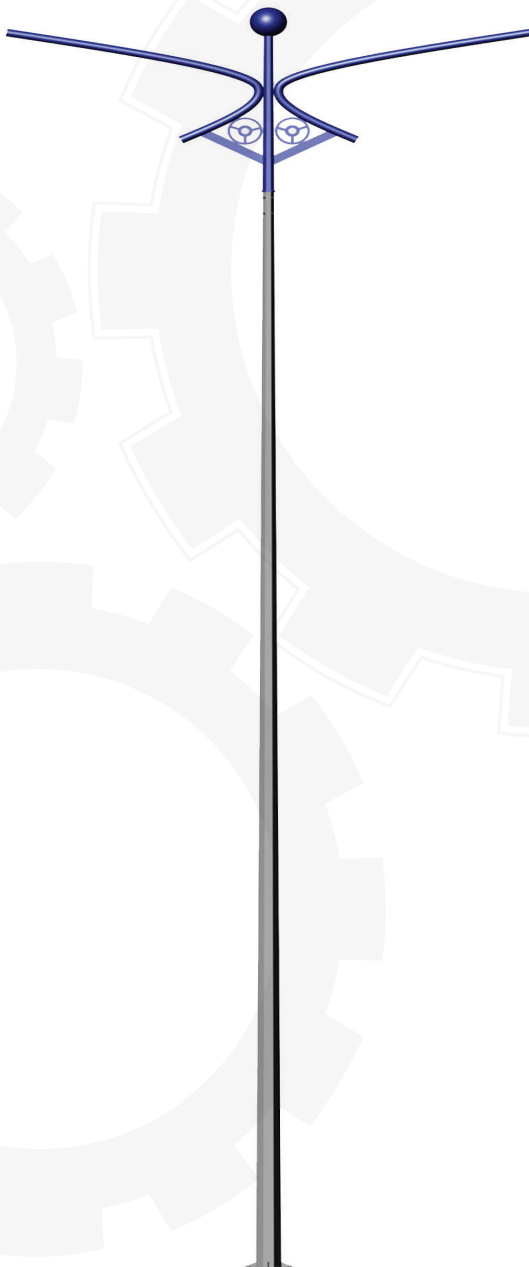

TECHNICAL DRAWING

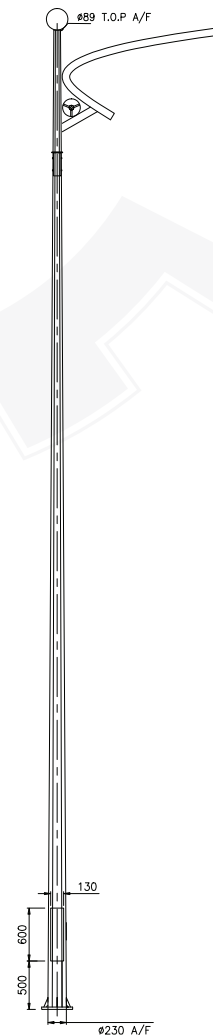

BRACKET DETAIL

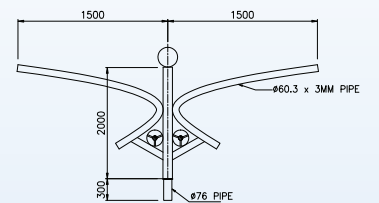

BASE PLATE DETAIL

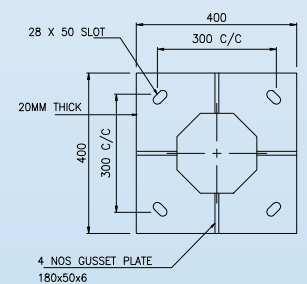

B.2 MS DECORATIVE POLES FOR ENTRANCES AND WALKWAY AREA: LONGITUDINAL POLE

RENDER

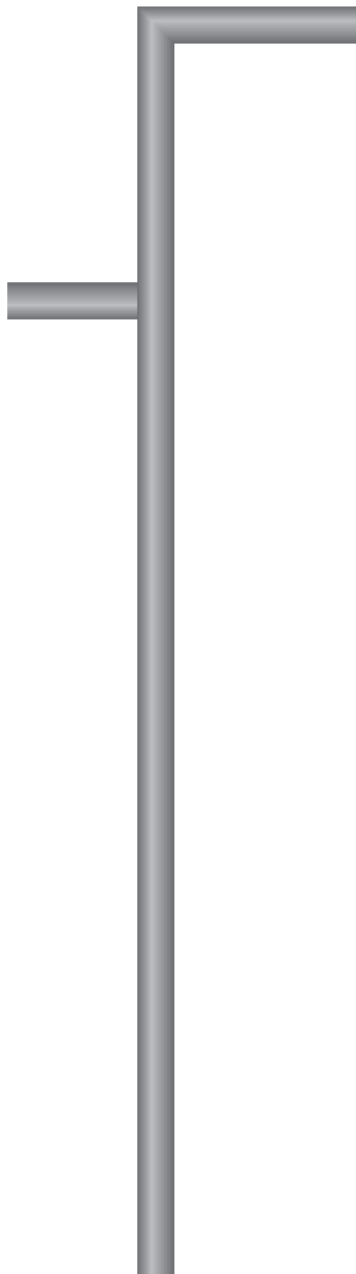

TECHNICAL DRAWING

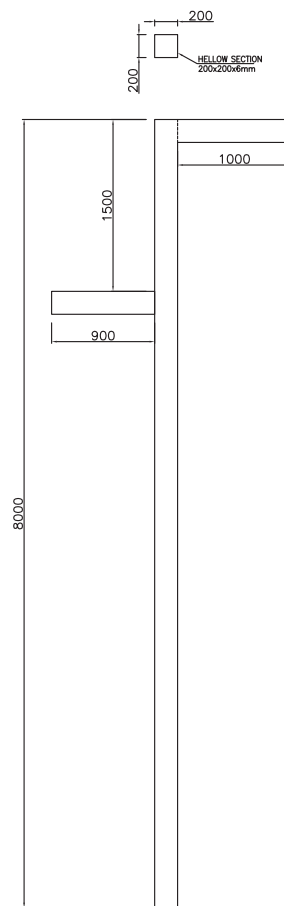

BRACKET DETAIL

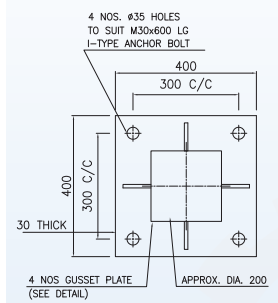

ANCHOR BOLT

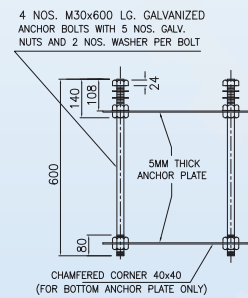

ANCHOR PLATE

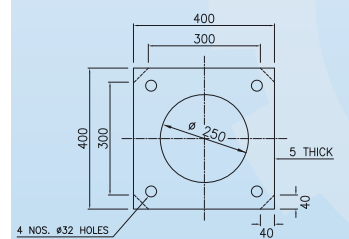

B.2 MS DECORATIVE POLES FOR ENTRANCES AND WALKWAY AREA: ARCH LONGITUDINAL POLE

RENDER



TECHNICAL DRAWING

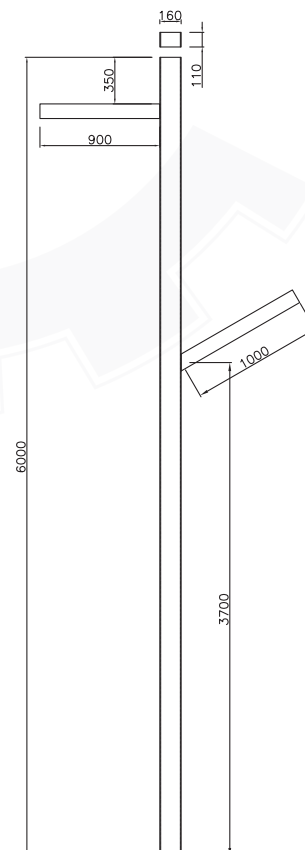

BRACKET DETAIL

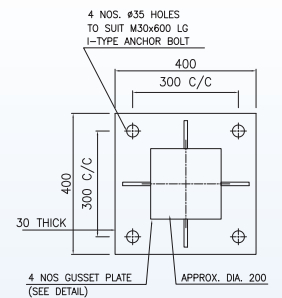

ANCHOR BOLT

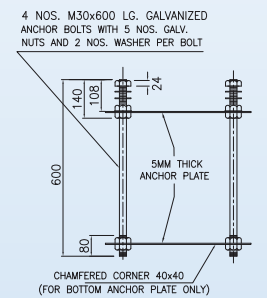

ANCHOR PLATE

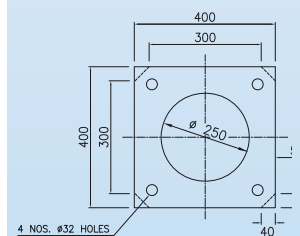



B.3 MESH POLES

1. GEOMETRIC MESH

2. ARABIAN MESH

3. ORIENTAL MESH



B.3 MESH POLES: GEOMETRIC MESH 1M



B.3 MESH POLES: GEOMETRIC MESH 1M

RENDER



TECHNICAL DRAWING

TYPE 1

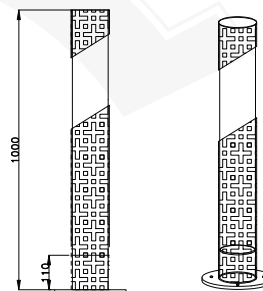

TYPE 2

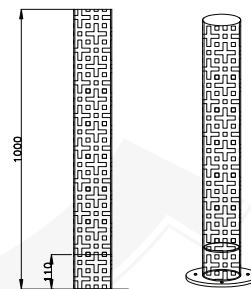

TYPE 3

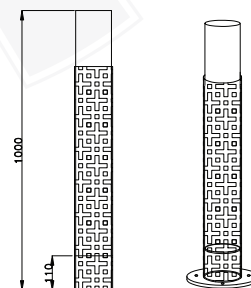

SHAFT WITH BASE PLATE

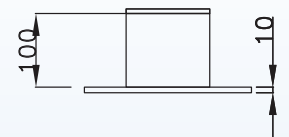

BASE PLATE

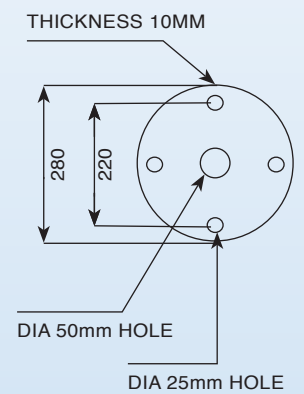



B.3 MESH POLES: ARABIAN MESH 1M



B.3 MESH POLES: ARABIAN MESH 1M

RENDER



TECHNICAL DRAWING

TYPE 1

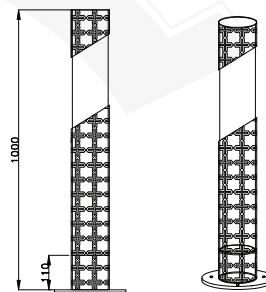

TYPE 2

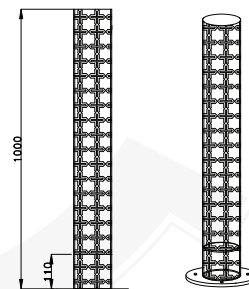

TYPE 3

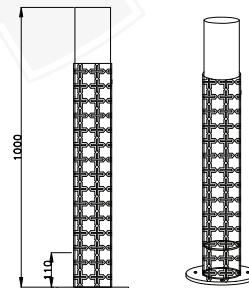

SHAFT WITH BASE PLATE

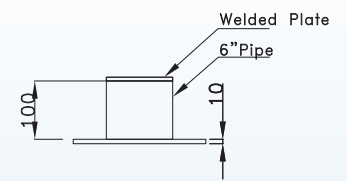

BASE PLATE

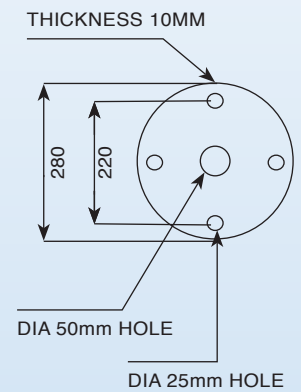

B.3 MESH POLES: ORIENTAL MESH 1M



B.3 MESH POLES: ORIENTAL MESH 1M

RENDER



TECHNICAL DRAWING

TYPE 1

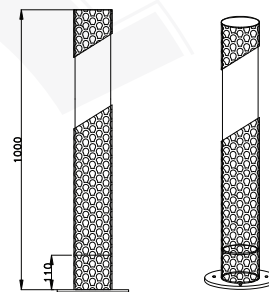

TYPE 2

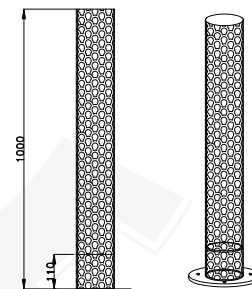

TYPE 3

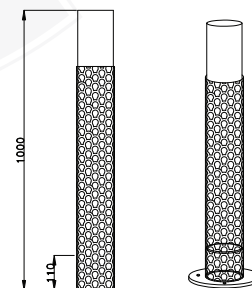

SHAFT WITH BASE PLATE

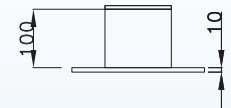

BASE PLATE

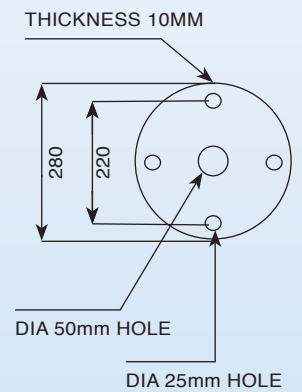

B.4 TREE POLES



B.4 TREE POLES

TECHNICAL DRAWING

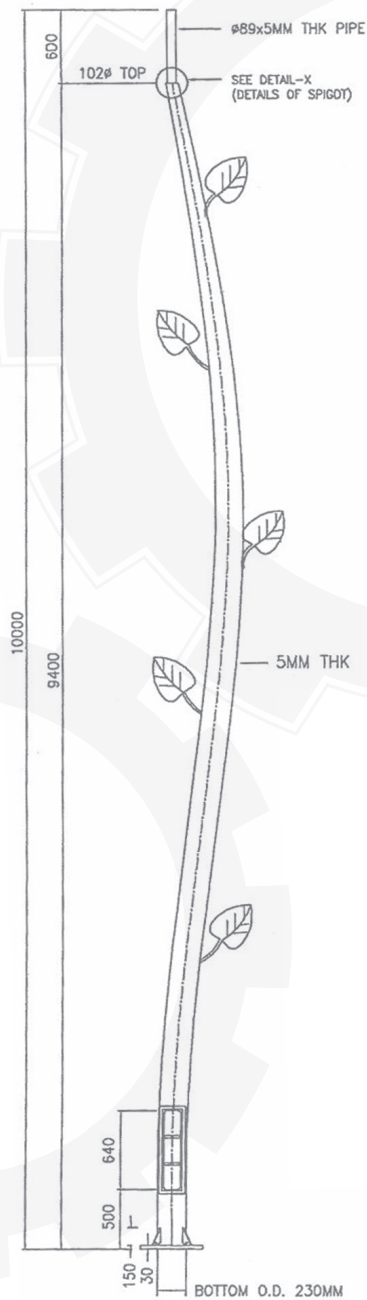

ANCHOR PLATE

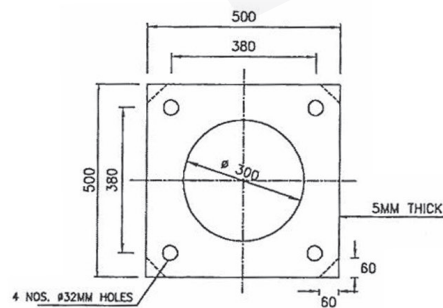

BASE PLATE

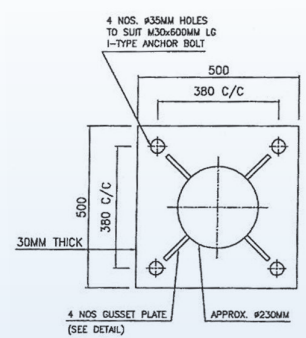



المير للصناعات ALMEER INDUSTRIES

HEAD OFFICE: P.O. Box 9240 Ahmadi, 61003 Kuwait

Tel. : +965 2398 6594 (10 Lines)

Hotline: 18 40 800

Fax : +965 2398 0682 / 6574

E-mail : atsco@almeer.com.kw

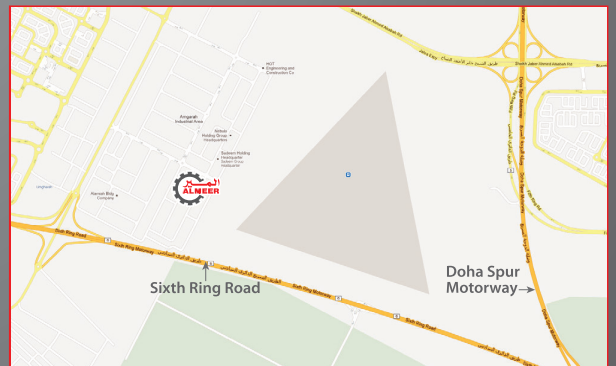

DUBAI BRANCH:

Almeer General Trading LLC.

Binary Tower -By Omnyat, 11th floor / office: 1104(A015)

Business Bay - Dubai

Tel: +971 4 871 5620

www.almeergeneraltrading.com

www.almeer.com.kw
www.almeerindustries.com

FACTORY: AMGHARA INDUSTRIAL AREA

Tel. : +965 2457 1395 / 4391

Fax : +965 2457 1396

E-mail : factory@almeer.com.kw